

DAIWA Tournament SS3000 / SS2600 / TS5000T QUICK-DRAG Conversion

The complete factory-fitted spool & drag knob assembly provides an effective clutch mechanism to the DAIWA Tournament series of big-pit reels. To go from fully 'locked up' to 'free spool' typically requires up to five full revolutions of the drag knob. QUICK-DRAG philosophy reduces the amount of turns required to go from fully 'locked up' to 'free spool', typically requiring approximately half a revolution of the drag knob,

In it's normal state, the clutch operates within a two-part process:

- The steel spring within the drag knob compresses with each clockwise revolution of the drag knob, imparting resistance on the spool washer assembly.
- Once the spring within the drag knob is fully compressed, the felt washers within the spool will also begin to compress - eliminating spool rotation gradually.

By replacing the spring within the drag knob assembly & the felt washers within the spool, this reduces the amount of turns of the drag knob required to impart compression on the spool washer assembly, allowing effective QUICK-DRAG operation.

STANDARD SPOOL & WASHER ASSEMBLY



STANDARD DRAG KNOB ASSEMBLY

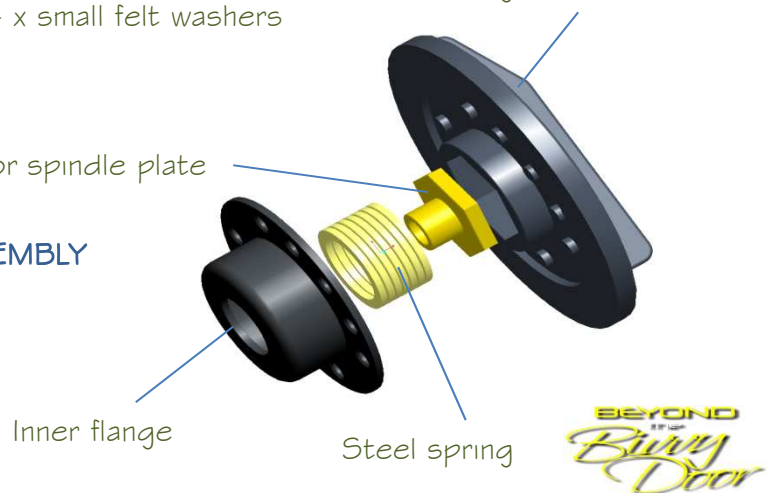

DAIWA Tournament SS3000 / SS2600 / TS5000T QUICK-DRAG Conversion

Conversion Process – Requirements

- 5 x Nylon / PTFE / Fibre washers:
 - Outer diameter = 22mm maximum
 - Inside diameter = 9.5mm minimum
 - Thickness = 0.85mm (Approx)
- 1 x Nylon / PTFE / Stainless Steel spacer.
 - Outer diameter = 13mm maximum
 - Inside diameter = 9.5mm minimum
 - Thickness = 8.0mm
 - Alternative = 8mm Stainless Steel nut bored to 10mm diameter + 6mm x 1mm Stainless steel washer

Conversion Process – Stage One

1. Remove the steel retaining clip from the inside of the spool housing, that retains the spool washer assembly.
2. Remove the spool washer assembly in sequence.
3. Remove the four felt washers & replace with Nylon, PTFE or Fibre washers.
4. Replace the washer assembly into the spool housing in reverse sequence.
5. Replace the retaining clip.

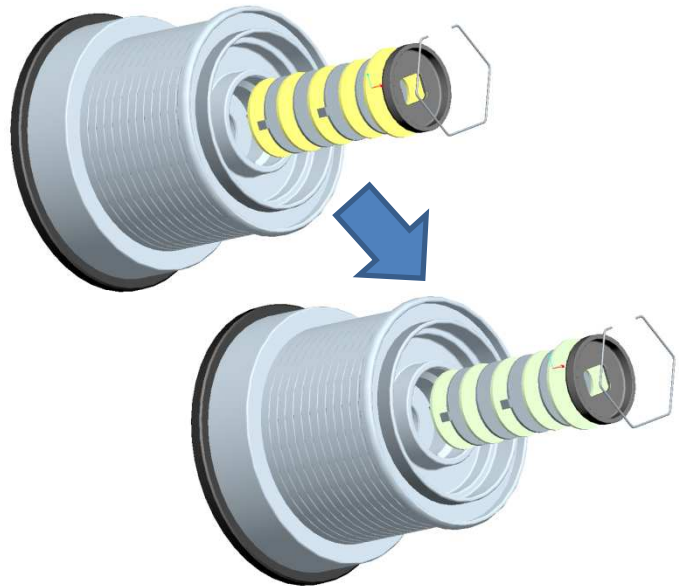

Conversion Process – Stage Two

1. Using a 3.5 / 4mm diameter drill bit, drill the tops off the 10 x plastic lugs that hold the two halves of the drag knob assembly together. Take care to centralise the drill bit in the middle of the plastic lug & stop drilling just as the drill bit makes contact with the metal inner flange.
2. Carefully prize the two halves of the assembly apart.
3. Remove the steel spring from within the drag knob assembly.
4. Replace the spring with a Nylon / PTFE / Stainless Steel spacer.
5. Check that the inner flange will relocate onto the 10 x plastic lugs (it may be necessary to tidy the tops of the lugs in order to get a decent fit).
6. With the two halves of the drag knob assembly separated, apply a small amount of epoxy resin around each plastic lug.
7. Locate the two halves of the drag knob assembly together, pressing firmly.
8. Wipe away any excess epoxy resin.
9. Leave drag knob for 24-hours to allow resin to cure fully.

DAIWA Tournament SS3000 / SS2600 / TS5000T QUICK-DRAG Conversion

In conclusion, this conversion requires a simple spacer, a few washers & a small amount of epoxy resin. It is not essential to adhere to the dimensions that have been provided here for these components – the following points are guidelines only:

- The washers used within the spool assembly must be able to pass over the reels' rotor spindle, but do not have to be a given thickness. As long as the total build-up of washers allows the retaining clip to locate in the retaining groove in the spool housing, it will still function correctly.

- The spacer required within the drag knob assembly can be substituted for an M8 stainless steel nut. However, this will not pass over the reels' rotor spindle – it will require drilling out to 9.5mm+. Additionally, this nut is typically 7mm thick – a small Stainless Steel washer behind the nut will be a sufficient addition.



The conversion is very simple to execute, & the only level of care required is with the separation of the drag knob assembly. Observe the following points:

- Use a good drill bit & don't force the drill through. Only a small amount of material is being removed during this operation.
- Drill the tops off the plastic lugs until the drill contacts the full periphery of the hole in the metal inner flange.
- Take care when prizing the two halves of the assembly apart. If you are using too much force, you haven't removed enough material from the lug tops.
- Only a small amount of epoxy resin is required to bond the two halves of the drag knob assembly back together.

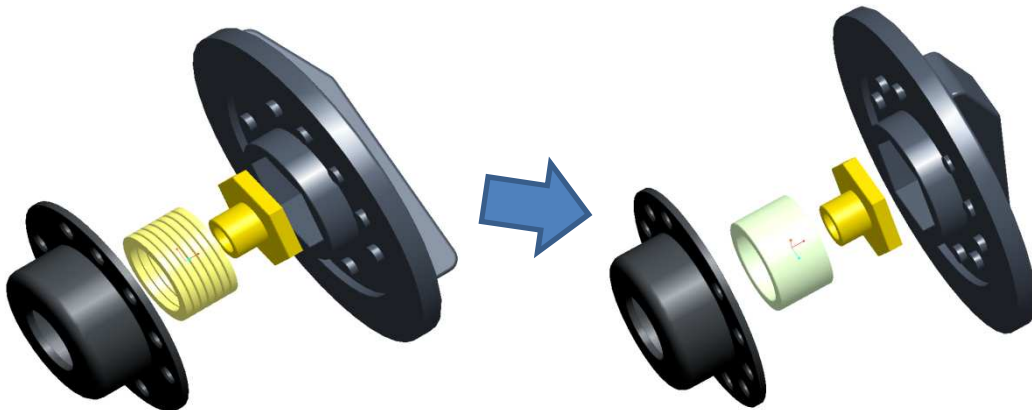

DAIWA Tournament SS3000 / SS2600 / TS5000T QUICK-DRAG Conversion

ENJOY ALL THE BENEFITS OF YOUR QUICK-DRAG CONVERTED DAIWA TOURNAMENT REEL!

SPOOL / DRAG KNOB ASSEMBLY PRIOR TO CONVERSION PROCESS

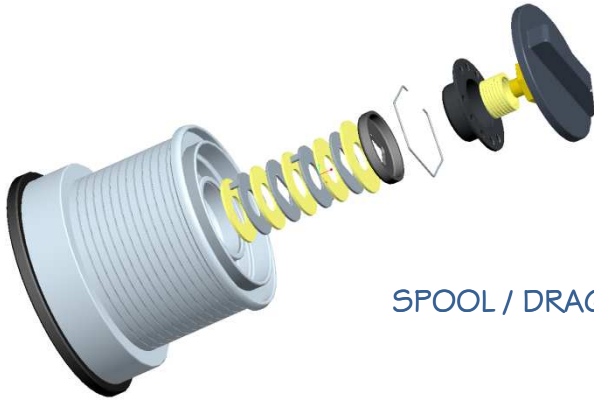

SPOOL / DRAG KNOB ASSEMBLY POST CONVERSION PROCESS

